

TUBE ELBOWS

TUBE O.D. ELBOWS

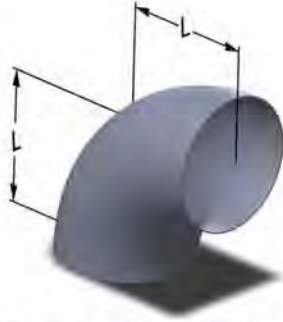

SR90 - SHORT RADIUS 90 DEGREE

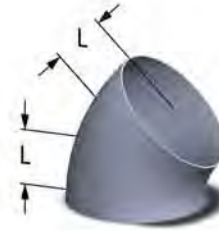

SR45 - SHORT RADIUS 90 DEGREE

TUBE O.D.	RADIUS	L	THK.	CARBON STEEL	T-304 S/S	RADIUS	L	THK.	CARBON STEEL	T-304 S/S
1-1/2"	1.50	1.50	0.065	SR90-0150	SR90-0150H	1.50	0.62	0.065	SR45-0150	SR45-0150H
2"	2.00	2.00	0.065	SR90-0200	SR90-0200H	2.00	0.83	0.065	SR45-0200	SR45-0200H
2-1/2"	2.50	2.50	0.065	SR90-0250	SR90-0250H	2.50	1.04	0.065	SR45-0250	SR45-0250H
3"	3.00	3.00	0.065	SR90-0300	SR90-0300H	3.00	1.24	0.065	SR45-0300	SR45-0300H
3-1/2"	3.50	3.50	0.065	SR90-0350	SR90-0350H	3.50	1.45	0.065	SR45-0350	SR45-0350H
4"	4.00	4.00	0.065	SR90-0400	SR90-0400H	4.00	1.66	0.065	SR45-0400	SR45-0400H
5"	5.50	5.50	0.065	SR90-0500	SR90-0500H	5.50	2.28	0.065	SR45-0500	SR45-0500H
5"	5.00	5.00	0.065	SR90-0500	SR90-0500H	5.00	2.07	0.065	SR45-0500	SR45-0500H
6"	6.00	6.00	0.065	SR90-0600	SR90-0600H	6.00	2.49	0.065	SR45-0600	SR45-0600H
8"	9.88	9.88	0.105	SR90-0800	SR90-0800H	9.88	4.09	0.105	SR45-0800	SR45-0800H
8"	8.00	8.00	0.105	SR90-0800-8	SR90-0800-8H	8.00	3.31	0.105	SR45-0800-8	SR45-0800-8H
10"	10.00	10.00	0.135	SR90-1000-10	N/A	10.00	4.14	0.135	SR45-1000-10	N/A
10"	11.00	11.00	0.135	SR90-1000-11	N/A	11.00	4.56	0.135	SR45-1000-11	N/A
12"	12.00	12.00	0.105	SR90-1200	SR90-1200H	12.00	4.97	0.105	SR45-1200	SR45-1200H
14"	14.00	14.00	0.135	N/A	SR90-1400H	14.00	5.80	0.135	N/A	SR45-1400H
16"	16.00	16.00	0.135	N/A	SR90-1600H	16.00	6.63	0.135	N/A	SR45-1600H
18"	18.00	18.00	0.135	N/A	SR90-1800H	18.00	7.46	0.135	N/A	SR45-1800H

LR90 - LONG RADIUS 90 DEGREE

LR45 - LONG RADIUS 90 DEGREE

TUBE O.D.	RADIUS	L	THK.	CARBON STEEL	T-304 S/S	RADIUS	L	THK.	CARBON STEEL	T-304 S/S
1-1/2"	3.00	3.00	0.065	LR90-0150	LR90-0150H	3.00	1.24	0.065	LR45-0150	LR45-0150H
2"	4.00	4.00	0.065	LR90-0200	LR90-0200H	4.00	1.66	0.065	LR45-0200	LR45-0200H
2-1/2"	5.00	5.00	0.065	LR90-0250	LR90-0250H	5.00	2.07	0.065	LR45-0250	LR45-0250H
3"	6.00	6.00	0.065	LR90-0300	LR90-0300H	6.00	2.49	0.065	LR45-0300	LR45-0300H
3-1/2"	7.00	7.00	0.065	LR90-0350	LR90-0350H	7.00	2.90	0.065	LR45-0350	LR45-0350H
4"	8.00	8.00	0.065	LR90-0400	LR90-0400H	8.00	3.31	0.065	LR45-0400	LR45-0400H
5"	10.00	10.00	0.065	LR90-0500	LR90-0500H	10.00	4.14	0.065	LR45-0500	LR45-0500H
6"	12.00	12.00	0.065	LR90-0600	LR90-0600H	12.00	4.97	0.065	LR45-0600	LR45-0600H
8"	12.00	12.00	0.105	N/A	LR90-0800H	12.00	4.97	0.105	N/A	LR45-0800H
10"	15.00	15.00	0.135	N/A	LR90-1000H	15.00	6.21	0.135	N/A	LR45-1000H
12"	18.00	18.00	0.105	N/A	LR90-1200H	18.00	7.46	0.105	N/A	LR45-1200H
14"	21.00	21.00	0.135	N/A	LR90-1400H	21.00	8.70	0.135	N/A	LR45-1400H
16"	24.00	24.00	0.135	N/A	LR90-1600H	24.00	9.94	0.135	N/A	LR45-1600H
18"	27.00	27.00	0.135	N/A	LR90-1800H	27.00	11.18	0.135	N/A	LR45-1800H

OPTIONS:

- T-316 Stainless Steel Available on Request.
- Elbows can be Cut in Any Degree Required.
Change "90" in the Part Number to the New Degree.



Contact One Of Our Product Specialists For Assistance



MITERED ELBOWS

**90 DEGREE
3 PCS CONSTRUCTION**

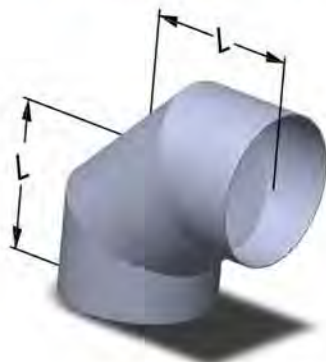

**90 DEGREE
4 PCS CONSTRUCTION**

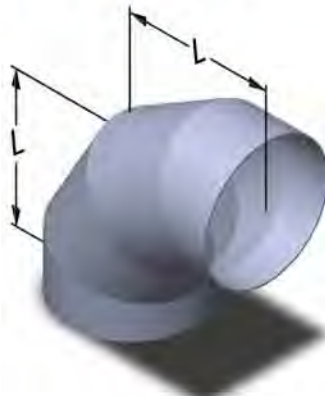

**45 DEGREE
2 PCS CONSTRUCTION**

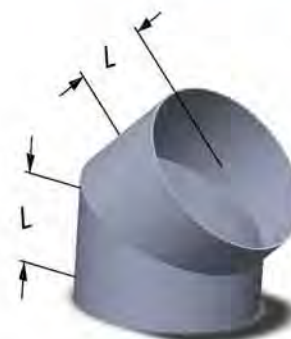

MT - LONG RADIUS

TUBE O.D.	RAD.	L	THK.	90° (3 PCS CONST.)		90° (4 PCS CONST.)		45° (2 PCS CONST.)		
				CARBON STEEL	T-304 S/S	CARBON STEEL	T-304 S/S	L	CARBON STEEL	T-304 S/S
14"	21.00	21.00	0.109	MT93-1400	MT93-1400H	MT94-1400	MT94-1400H	8.75	MT42-1400	MT42-1400H
16"	24.00	24.00	0.109	MT93-1600	MT93-1600H	MT94-1600	MT94-1600H	10.00	MT42-1600	MT42-1600H
18"	27.00	27.00	0.109	MT93-1800	MT93-1800H	MT94-1800	MT94-1800H	11.25	MT42-1800	MT42-1800H
20"	30.00	30.00	0.134	MT93-2000	MT93-2000H	MT94-2000	MT94-2000H	12.50	MT42-2000	MT42-2000H
22"	33.00	33.00	0.134	MT93-2200	MT93-2200H	MT94-2200	MT94-2200H	13.75	MT42-2200	MT42-2200H
24"	36.00	36.00	0.134	MT93-2400	MT93-2400H	MT94-2400	MT94-2400H	15.00	MT42-2400	MT42-2400H

SMT - SHORT RADIUS

TUBE O.D.	RAD.	L	THK.	90° (3 PCS CONST.)		90° (4 PCS CONST.)	
				CARBON STEEL	T-304 S/S	CARBON STEEL	T-304 S/S
14"	14.00	14.00	0.109	SMT93-1400	SMT93-1400H	SMT94-1400	SMT94-1400H
16"	16.00	16.00	0.109	SMT93-1600	SMT93-1600H	SMT94-1600	SMT94-1600H
18"	18.00	18.00	0.109	SMT93-1800	SMT93-1800H	SMT94-1800	SMT94-1800H
20"	20.00	20.00	0.134	SMT93-2000	SMT93-2000H	SMT94-2000	SMT94-2000H
22"	22.00	22.00	0.134	SMT93-2200	SMT93-2200H	SMT94-2200	SMT94-2200H
24"	24.00	24.00	0.134	SMT93-2400	SMT93-2400H	SMT94-2400	SMT94-2400H



OPTIONS:

- Heavy Wall Construction Up to 3/8" Thk Available.
- Elbows can be Made in Any Degree Required.
- Longer "L" Dimension Available.
- Flanged Ends Available.
- T-316 Stainless Steel Available on Request.

Contact One Of Our Product Specialists For Assistance



TUBE ELBOWS

TUBE ELBOWS WITH TANGENT ENDS



PE - PLAIN TUBE ENDS



PS - PLAIN TUBE ENDS X SLOTTED CUFF



SC - SLOTTED CUFF ENDS

S/R ELBOW				PLAIN ENDS		PLAIN X SLOTTED		SLOTTED ENDS	
TUBE O.D.	RAD.	L	THK.	CARBON STEEL	T-304 S/S	CARBON STEEL	T-304 S/S	CARBON STEEL	T-304 S/S
2"	2.00	6.00	0.065	PE0200	PE0200H	PS0200	PS0200H	SC0200	SC0200H
2-1/2"	2.50	6.50	0.065	PE0250	PE0250H	PS0250	PS0250H	SC0250	SC0250H
3"	3.00	7.00	0.065	PE0300	PE0300H	PS0300	PS0300H	SC0300	SC0300H
3-1/2"	3.50	7.50	0.065	PE0350	PE0350H	PS0350	PS0350H	SC0350	SC0350H
4"	4.00	8.00	0.065	PE0400	PE0400H	PS0400	PS0400H	SC0400	SC0400H
5"	5.00	9.50	0.065	PE0500	PE0500H	PS0500	PS0500H	SC0500	SC0500H
6"	6.00	10.00	0.065	PE0600	PE0600H	PS0600	PS0600H	SC0600	SC0600H
8"	8.00	13.88	0.109	PE0800	PE0800H	PS0800	PS0800H	SC0800	SC0800H
10"	10.00	14.00	0.135	PE1000	PE1000H	PS1000	PS1000H	SC1000	SC1000H
12"	12.00	16.00	0.109	PE1200	PE1200H	PS1200	PS1200H	SC1200	SC1200H
14"	14.00	18.00	0.109	N/A	PE1400H	N/A	N/A	N/A	N/A
16"	16.00	20.00	0.135	N/A	PE1600H	N/A	N/A	N/A	N/A
18"	18.00	22.00	0.135	N/A	PE1800H	N/A	N/A	N/A	N/A

L/R ELBOW				PLAIN ENDS		PLAIN X SLOTTED		SLOTTED ENDS	
TUBE O.D.	RAD.	L	THK.	CARBON STEEL	T-304 S/S	CARBON STEEL	T-304 S/S	CARBON STEEL	T-304 S/S
2"	4.00	8.00	0.065	PEL0200	PEL0200H	PSL0200	PSL0200H	SCL0200	SCL0200H
2-1/2"	5.00	9.00	0.065	PEL0250	PEL0250H	PSL0250	PSL0250H	SCL0250	SCL0250H
3"	6.00	10.00	0.065	PEL0300	PEL0300H	PSL0300	PSL0300H	SCL0300	SCL0300H
3-1/2"	7.00	11.00	0.065	PEL0350	PEL0350H	PSL0350	PSL0350H	SCL0350	SCL0350H
4"	8.00	12.00	0.065	PEL0400	PEL0400H	PSL0400	PSL0400H	SCL0400	SCL0400H
5"	10.00	14.00	0.065	PEL0500	PEL0500H	PSL0500	PSL0500H	SCL0500	SCL0500H
6"	12.00	16.00	0.065	PEL0600	PEL0600H	PSL0600	PSL0600H	SCL0600	SCL0600H
8"	12.00	16.00	0.109	N/A	PEL0800H	N/A	PSL0800H	N/A	SCL0800H
10"	15.00	19.00	0.135	N/A	PEL1000H	N/A	PSL1000H	N/A	SCL1000H
12"	18.00	22.00	0.109	N/A	PEL1200H	N/A	PSL1200H	N/A	SCL1200H
14"	21.00	25.00	0.109	N/A	PEL1400H	N/A	N/A	N/A	N/A
16"	24.00	28.00	0.135	N/A	PEL1600H	N/A	N/A	N/A	N/A
18"	27.00	31.00	0.135	N/A	PEL1800H	N/A	N/A	N/A	N/A

NOTES:

- Slotted Cuffs are Tube Size.

OPTIONS:

- Transition Cuffs for Size Reduction.
- Longer / Shorter Lengths Available.
- Pipe Size Cuffs are Available.
- Flanged Ends Available.
- T-316 Stainless Steel Available on Request.



Contact One Of Our Product Specialists For Assistance

